



Cohousing in Corvallis

An E Newsletter from CoHo Cohousing
Corvallis, Oregon

Issue 32 March 2007



Remember when your best friend lived right next door?

Living in South Corvallis

When CoHoots were looking for a site several years ago, they wanted a spot close to downtown with a strong community feel, diverse neighbors, and some open space. Our 6.8 acre site at Alexander and Crystal Lake Drive in South Corvallis is a great fit.

The South Corvallis neighborhood was profiled in the Gazette Times earlier this year and CoHoots were reminded again why this area is so appealing. More than 50 neighbors (including 4 CoHoots) met to talk about their neighborhood—past and present. George Grosch, city councilor for Ward 3, summarized "This is probably the most diverse neighborhood in Corvallis. There's a variety of incomes down here, there's a variety of ages, of ethnicities in this neighborhood."

Photo at left: South Corvallis neighbors work on trail maintenance



Recently, CoHoots shared their excitement about living in South Corvallis. Jeremy is looking forward to having his daughters enrolled at nearby Lincoln School, especially because of their dual immersion language program. "The neighborhood has a good feeling to it, with friendly people and without the isolation of new housing developments. We also like the quiet of the neighborhood without the noise, hustle and bustle of downtown."



In addition to enjoying half-hourly bus service on route #6 (along with "the best looking bus shelter in the county" at Ryan & Alexander, one block from CoHo), CoHoots are planning to bike. John Jo and Elizabeth are looking



forward to riding in a bicycle-friendly area. Dave, Aria, and Joey plan to triple up to shop at the Coop with their bike trailer. They're also eager to walk to nearby parks and the river, building friendships with other sustainably-oriented people in South Corvallis.

Jessica adds: "I hear there's a lot of community interaction and focus on ecological sustainability among many South Corvallis residents. I'm really looking forward to not only living in a cohousing community, but also being part of a wider community in which those values are common."

And...a gentle Haiku from Rob, Jen and Skya...

Playing in the parks
CoHo friends, rivers, trees, green
Fine community

A Neighborly Neighbor

If you've seen a CoHo presentation at a [Willamette Neighborhood Housing Services First-Time Homebuyers Class](#) or attended a CoHo orientation, chances are you've met [Valerie](#). She is often one of the first folks to meet and greet visitors and share her enthusiasm for community living. At almost any CoHo event, Valerie can be spotted shooting many, many photos. Her imaginative photos have been shared in our [newsletters](#) and [website photo albums](#).



Valerie has already made connections with some of our neighbors in South Corvallis, joining them for a trail-building workday a few months ago. For the past several years, Valerie and her family have joined with other "green thumb" wizards to plant, tend, and harvest a large organic garden just outside Corvallis. Valerie's unique contribution is growing the "starts," the seedlings that are replanted when they're ready for the garden. With her ready smile and knack for nurturing and growing, Valerie is a natural in her role on CoHo's Marketing Committee.

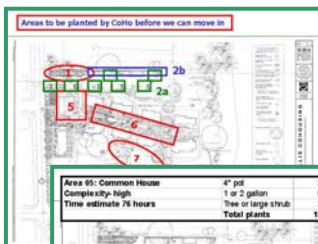

Landscaping Plans Unfurled

The overwhelming reaction to [Nancy's](#) presentation on CoHo's landscaping plans was WOW! CoHoots were treated to a dazzling display of site layouts with multiple zones, photos of plants/trees/shrubs, estimates of labor, and well-orchestrated plans for overall coordination. Zone Coordinators were recruited to oversee the work in different areas. Our Landscaping Committee will be providing overall coordination for plant procurement, tool collection, recruitment of helpers, etc.

Area 01: Common House	4" pot	25
Complexity: High	1 or 2 gallon	54
Time estimate 7/8 hours	Tree or large shrub	33
	Total plants	112

An estimated 381 hours of planting time (not including planning time) will need to be completed prior to move-in, with more projects to follow after CoHoots are living on site. Volunteer help is definitely appreciated!

A Home for [Mike](#) (by Debby)

Just about everyone who knows CoHo, knows Mike. With his infectious smile and unflagging optimism, he rarely misses a meeting or community event. Diagnosed with multiple sclerosis almost 30 years ago, Mike now has no voluntary movement below his neck and is legally blind. The connection to community is important to all CoHo members, but none more than Mike. He has contributed a great deal to the community and is currently serving as our President. Although Mike has been active for years in helping to establish CoHo, he always knew he couldn't afford to purchase a home here. Now that the buildings are finally under construction, A Home in Community is raising the funds to purchase an ADA unit in CoHo that will be rented at a subsidized rate to low-income individuals with disabilities...beginning with Mike! Our goal is to raise \$214,000 by July 2007. We are within days of launching our website but are already accepting donations, tax deductible status pending. Checks can be made payable to A Home in Community and sent to P.O. Box 1733, Corvallis, OR 97339-1733. For additional information, contact Juva at Juva@Alyrica.Net or 541-908-5882.



March Site Tour

CoHoots and friends enjoy close-up previews of our homes and Common House at our monthly site tours. Many CoHoots got their first glimpse of windows, roofs, balconies, stairs, AND the first wall of the Common House (put in place on the day of the tour, to be followed by more walls and roof framing within the next week).



Meanwhile, buildings 4 and 5 are being dried out in preparation for the start of interior finish work. The outsides of these buildings are now covered in Tyvek, a weather protective barrier that will later be covered with siding.

Our contractor highlighted more "green" features in our project. Our windows are fully insulated, low-E glass. Our roofs are offset, with more south-facing square footage so photovoltaic panels could be added in the future. Homes are constructed with advanced framing which uses fewer studs and more insulation.



While CoHoots explored, measured, took LOTS of photos, opened doors, climbed stairs, and checked out the views...

...Bruce daydreamed about the day when he'd be able to park in our large bike barn...

...and Renee and Esabelle enjoyed their first month as South Corvallis residents.

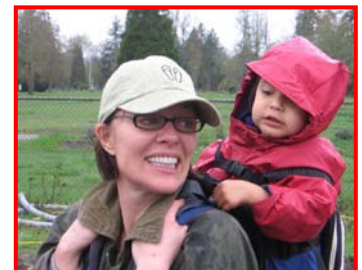

Two Homes Available in CoHo

The two remaining homes will be sold to income-eligible buyers (for some of the loan packages, you DON'T have to be a first-time homebuyer). For more info on income and asset criteria for a variety of loan packages, contact Ken Smith at Willamette Neighborhood Housing Services (WNHS) at 541-752-7220 or 800-403-0957.



NOT income-eligible? Afraid there isn't a home available for you? Cohousing projects usually have a few homes turn over within the year before move-in. Check us out. If you think this might be the place for you, consider starting the membership process now and you'll be ready to step in when things change.

If you'd like to meet CoHoots and explore the possibility of membership, join us for an orientation on Saturday, April 21st at 5:00pm, followed by a Meet & Greet with our first vegetarian "real meal" prepared by a Meal Crew of CoHoots at 6:00pm at 101 NW 23rd St (corner of Monroe and 23rd across from the OSU campus). **Please RSVP to Anne at 541-974-1739.**

To find out more about CoHo Cohousing

Website: www.cohoecovillage.org
Email: cohocontact@cohoecovillage.org
Phone: [Anne Arquette @ 541-974-1739](tel:541-974-1739)



Esabelle shares a neighborly hug with Juva and Anne at St. Patrick's Day Picnic in the Park



CoHo canine neighbors Barclay (Esabelle and Renee's golden dog) and Marfa (Anne's black dog) meet for the first time at the picnic

Click [HERE](#) to read issues of previous newsletters on our website.
Share this link with someone who may be interested in CoHo!

